



Part # 12274010- 2015-up Mustang Rear CoolRide Kit

Recommended Tools

Rear Components:

12274099 Rear CoolRide Instructions
12270701 Rear HQ Series Shocks



2015-up Mustang Rear CoolRide Kit Installation Instructions

Table of contents

Pages 2-5..... Rear CoolRide
Pages 6-8..... Rear HQ Series Shocks

THE SHOCKS IN THIS KIT WILL NOT FIT THE GT350!!





Part # 12274099 - 2015 up Mustang Rear CoolRide

Recommended Tools

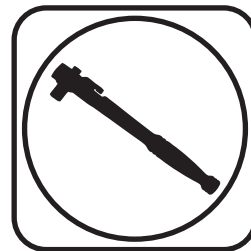
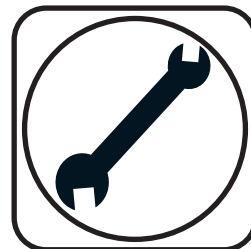
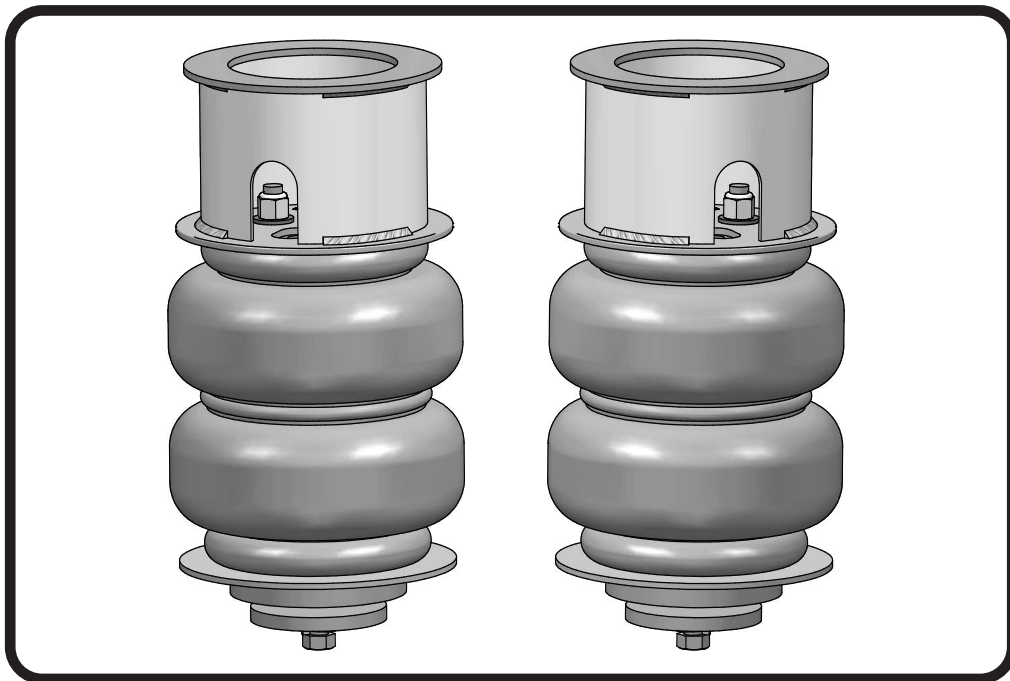

2015 up Mustang Rear CoolRide

Installation Instructions

Table of contents

Page 9.....	Included components & Getting Started
Page 10.....	CoolRide Installation
Page 11.....	CoolRide Installation

THIS KIT IS DESIGNED TO BE USED WITH RIDETECH HQ SERIES SHOCKS KIT # 12270701.





Major ComponentsIn the box

Item	Part #	Description	QTY
1	90002484	Upper Cup Bracket	2
2	90006781	6.5" Diameter Air Spring	2
3	90002485	Lower Cup Bracket	2
4	90002486	Lower Clamping Plate	2
5	99373003	3/8" Flat Washer	6
6	99372002	3/8"-16 Nylok Nut	4
7	99373005	3/8" Split Lock Washer	2
8	99371006	3/8"-16 x 1 1/2" Hex Bolt	2

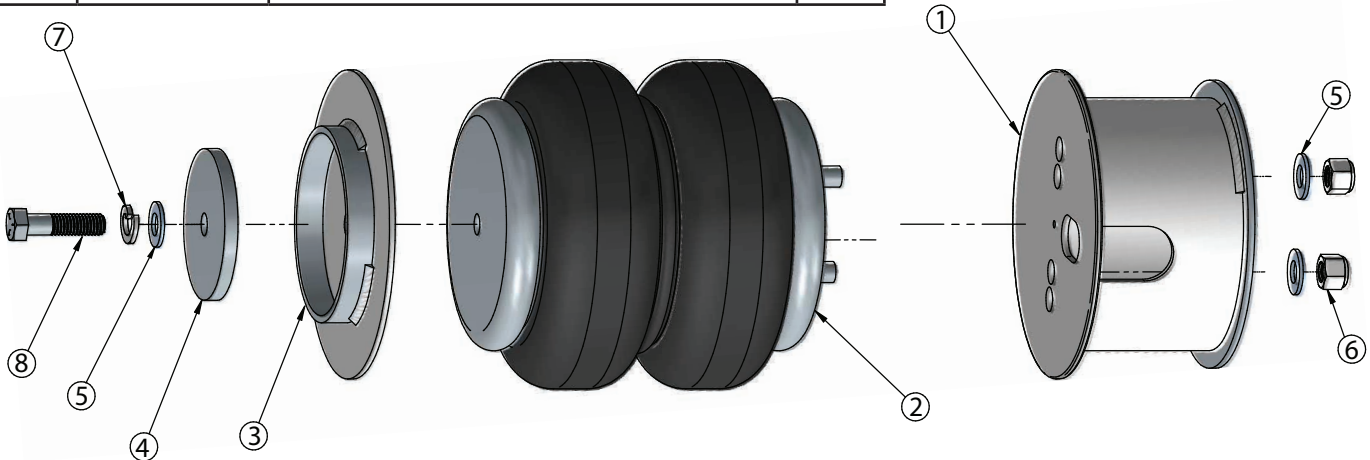

Getting Started and Disassembly

Congratulations on your purchase of the Ridetech Mustang CoolRide System. This system has been designed to give your Mustang excellent handling along with a lifetime of enjoyment. The CoolRide System provides flexibility that can not be achieved with Conventional Coil Springs. The CoolRide System, used in conjunction with HQ Series rear shocks, will give you the flexibility of adjusting your ride height along with the ability to dial in your ride quality to your personal preference.

This CoolRide System is Designed to replace the factory Coil Springs. It should be installed at the same time as the rear shocks, kit # 12270701

Refer to the Factory Service Manual for disassembly and Coilspring removal instructions.

1. Remove the Shocks and the OEM Upper Shock Mount from the Car.
2. Disconnect the Sway Bar Linkage from the Control Arms. These will be reinstalled.



CoolRide Installation

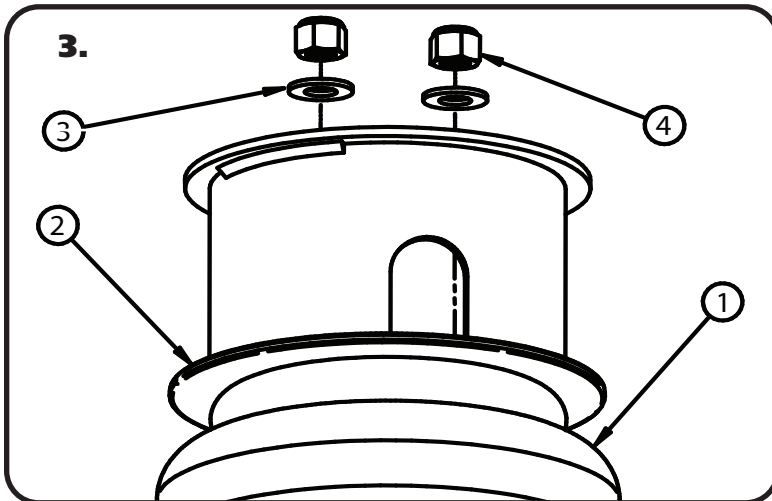

3. Thread a 90 Degree Fitting into the Air Spring with Thread Sealant applied to the threads. Place the Upper Cup Bracket(2) on to the top of the Air Spring(1). Next, install a 3/8" Flat Washer(3) on each threaded stud, followed by a 3/8"-16" Nylok Nut(4). Torque Nuts to 15-20ftlbs.

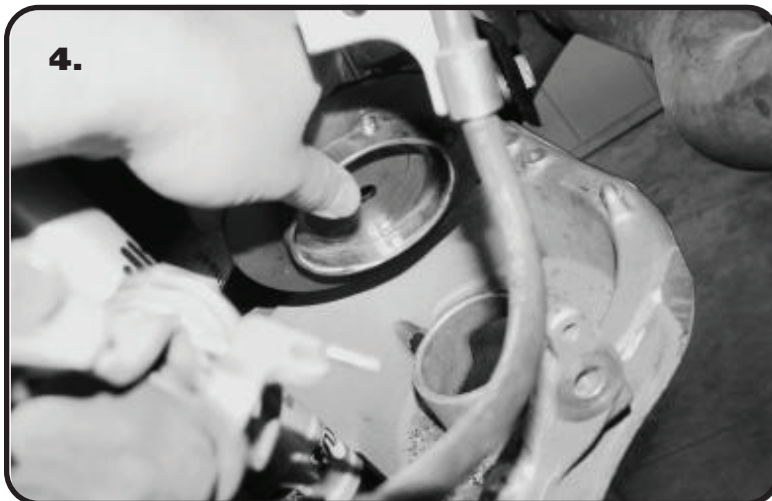

4. Install the Lower Cup Bracket into the OEM coil spring pocket of the control arm. The Cup Bracket is installed with the bottom ring located around the coil spring centering ring on the control arm.

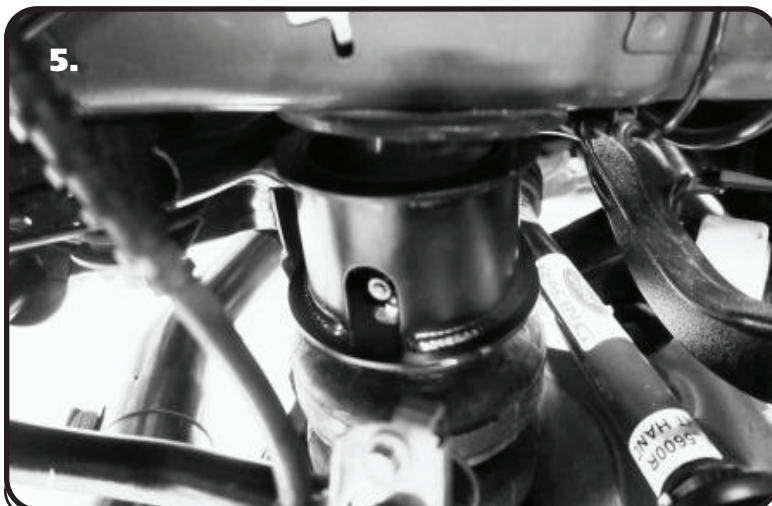

5. Install the Air Spring/Upper Cup Assembly into the OEM coil spring location. The top of the Upper Cup will sit in the OEM coil spring location. Clock the fitting to the front of the car, but be sure you have access to it to install the air line. The bottom of the Air Spring will sit on top of the Lower Cup Bracket.



CoolRide Installation

6.

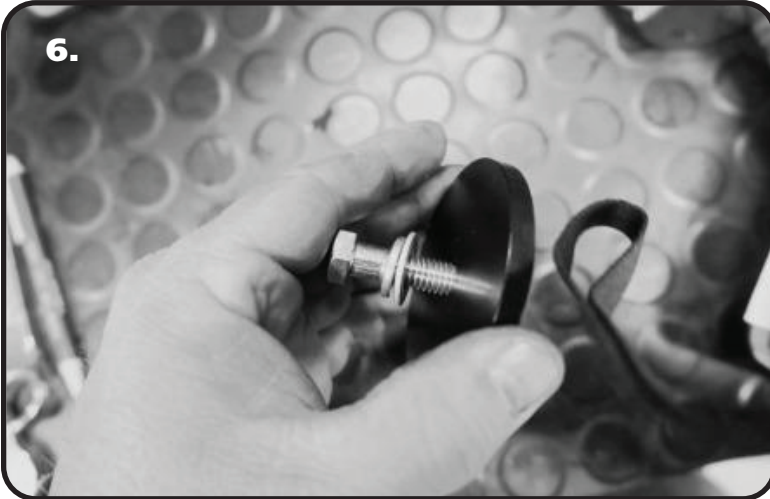

6. Install a 3/8" Split Lock Washer, followed by a 3/8" Flat Washer, on the 3/8"-16 x 1 1/2" Hex Bolt. Insert the Bolt into the hole in the Clamping Plate.

7.

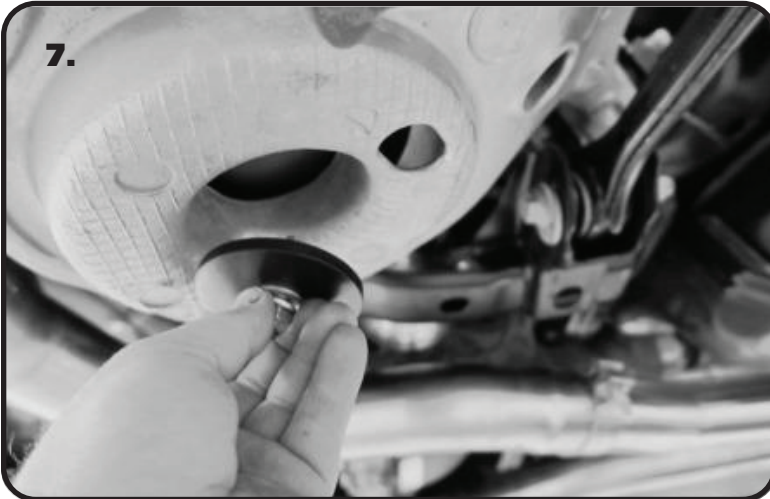

7. Move the Air Spring around until the threaded hole lines up with the holes in the Lower Cup Bracket. Insert the Clamping Plate into the coil spring centering ring hole in the bottom of the lower control arm, threading the 3/8"-16 Hex Bolt into the bottom of the Air Spring. Hold the Air Spring to keep the fitting hole in the correct location and Torque the 3/8" Hex Bolt to 15-20 ftlbs.

8. Install your HQ Series Shocks and Air Control System before putting the car back on the ground.

Ride Height

We have designed most cars to have a ride height of about 1 1/2" lower than factory. It will take approximately 80psi to achieve ride height. The air pressure will vary due to driver preference and accessories installed in the vehicle.



Part # 12270701 - 2015-up Mustang HQ Series Shocks



Recommended Tools

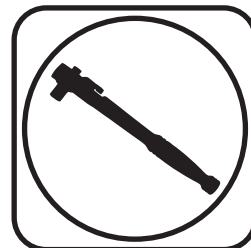

2015-up Mustang HQ Series Rear Shocks Installation Instructions

Table of contents

Page	7.....	Components & Shock Installation
Page	8.....	Shock Installation & Adjustment

THIS KIT IS DESIGNED TO BE USED WITH RIDETECH COOLRIDE AIR SPRING KIT # 12274099.





HQ Series Smooth Body Shocks

Major ComponentsIn the box

Part #	Description	QTY
986-10-081	6.65" Stroke Shock	2
70011139	5/8" ID Shock Bushing (Installed in Shock)	2
90002068	Wide Trunnion (Installed in Shock)	2
70012354	Upper Mounting Spacers	4
99372006	3/8"-24 Thin Jam Nut	4
99311022	5/16"-18 x 1 3/4" Hex Bolt	4
99313002	5/16" Flat Washer	8
99312002	5/16"-18 Nylok Nut	4

Shock Installation

This shock kit should be installed at the same time as the rear CoolRide Kit.

Refer to the Factory Service Manual for disassembly and Coilspring removal instructions.

1. Remove the Shocks and the OEM Upper Shock Mount from the Car.
2. Disconnect the Sway Bar Linkage from the Control Arms. These will be reinstalled.

3.

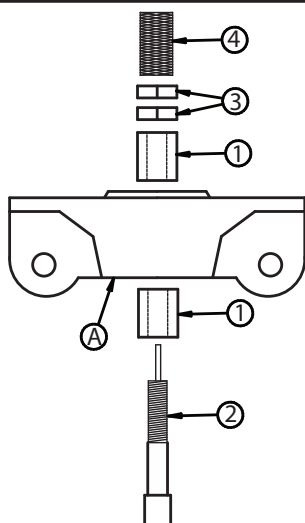

3. The HQ Series Shock bolts into the stock location using the OEM upper mount(A). Install an Aluminum Spacer(1) on the Shock Shaft(2). Insert the Shock Shaft into the OEM shock mount. Install a 2nd Aluminum Spacer(1) onto the shock shaft. Thread a 3/8"-24 Lock Nut(3) onto the Shock Shaft and tighten. Install a 2nd 3/8"-24 Lock Nut on the shock shaft and tighten against the 1st lock nut. Install the Adjuster Knob(4). Install the Assembly into the OEM location. Repeat for both sides. Torque the OEM Bolt to 65ftlbs.



Shock Installation and Adjustment

2.

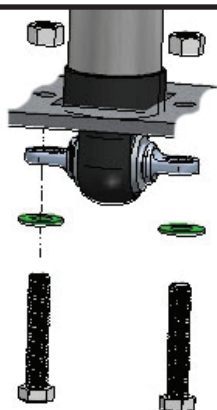

2. Attach the Trunnion to the OEM Control arm using the supplied Hardware. It may be necessary to rotate the Trunnion to get it in the correct position. This can be done by sticking a screwdriver in one of the slots and spinning the trunnion in the shock bushing. Torque the hardware to 17ftlbs. Do this for both sides. Reattached the sway bar linkage.

The CoolRide kit should already be installed, if not, do it at this time and lower the rear of the car to the ground.

Shock adjustment 101- Single Adjustable

Rebound Adjustment:

How to adjust your new shocks

The rebound adjustment knob is located on the top of the shock absorber protruding from the eyelet or stud top. You must first begin at the ZERO setting, then set the shock to a street setting of 12 or handling setting of 8.



-Begin with the shocks adjusted to the ZERO rebound position (full stiff). Do this by rotating the rebound adjuster knob clockwise until it stops.

-Now turn the rebound adjuster knob counter clockwise 12 clicks. This sets the shock at 12 for a street setting. If you are after a handling setting only go 8 clicks.

Take the vehicle for a test drive.



-if you are satisfied with the ride quality, do not do anything, you are set!

-if the vehicle is too soft increase the damping effect by rotating the rebound knob clockwise 3 additional clicks.

-If the vehicle is too stiff rotate the rebound adjustment knob counter clock wise 2 clicks and you are set!

Take the vehicle for another test drive and repeat the above steps until the ride quality is satisfactory.

Note:

One end of the vehicle will likely reach the desired setting before the other end. If this happens stop adjusting the satisfied end and keep adjusting the unsatisfied end until the overall ride quality is satisfactory.