



350 S. St. Charles St. Jasper, In. 47546

Ph. 812.482.2932 Fax 812.634.6632

[www.ridetech.com](http://www.ridetech.com)

**41240000 68-72 GM "A" Body TigerCage**

**Basic Cage**

1	41240904	Main Hoop
1	41240908	Driver side hoop mount
1	41240907	Passenger side hoop floor mount
2	41240905	Hoop to frame mount (inner, front)
1	41240910	Driver side hoop to frame mount (inner, rear)
1	41240909	Passenger side hoop to frame mount (inner, rear)
1	41240913	Driver side hoop to frame mount (outer)
1	41240912	Passenger side hoop to frame mount (outer)
1	41240903	Driver side package tray bar
1	41240902	Passenger side package tray bar
2	41240911	Package tray reinforcement plate
1	41240901	Driver side trunk bar
1	41240900	Passenger side trunk bar
2	41240906	Trunk bar to frame mount
2	49990005	Clamp tabs
1	49990003	TigerClamp P (threaded)
1	49990001	TigerClamp P
1	49990004	TigerClamp D (threaded)
1	49990000	TigerClamp D
1	90002276	Tube of Anti-Seize
1	41249900	(ENG34115) Polyurethane body mount kit

**Hardware:**

16	99371023	3/8" x 1" USS Gr. 8 SHCS	Clamps / Main hoop to mount
46	99371004	3/8" x 1 1/4" USS Gr. 8 bolt	Mounting brackets
12	99373007	3/8" x 1" self-tapping screws	Mounting brackets
46	99372001	3/8" USS Gr.8 Nylok nut	Mounting brackets
12	99373005	3/8" Lock washer	Mounting brackets
104	99373002	3/8" SAE flat washer	Mounting brackets
2	49990008	1/2" x 1 1/2" 12 point Gr. 8 bolt	Bar to clamp tab
2	49990009	1/2" Flange nut	Bar to clamp tab



**41240908**



**41240910**



**41240913**



**41240905**



**41240911**



**41240906**

## 41240000 Installation Instructions

- Initial fitment of the floor mount brackets must be done under the carpet. Final installation can be done under or over the carpet.
- Use Anti-Seize on all fasteners that are threaded into stainless clamps or brackets.
- Install all bars before final tightening.
- Always tighten the tab side of the clamp first.
- Torque all 3/8" fasteners to 45 ft-lbs and all 1/2" fasteners to 75 ft-lbs.
- Make sure the clamp is exactly where you want it before tightening as the clamp may scratch the tubing.
- **Watch for fuel and brake lines when drilling holes through the floor pan.**



1. Start by replacing all of the body mounts with the new polyurethane mounts included. Using the old rubber mounts can cause clearance and fitment issues.

2. Position the main hoop floor mount so that the front of it is 38 5/8" behind the pinch weld at the front of the door opening.

3. Using the bracket as a template; drill six 3/8" holes through the floor pan. Drop 3/8" x 1 1/4" bolt w/ flat washers down through floor pan.



4. Bolt the frame brackets to the bottom of the floor pan using 3/8" Nylok nuts and flat washers. These two brackets attach to the inside of the frame rail.

5. The frame should be drilled with a 3/8" bit for the **rear bracket**. Use 3/8" x 1 1/4" Nylok nut and flat washers to secure the bracket to the frame.

6. The holes for the **front** bracket need to be drilled with a 5/16". A 3/8" x 1" self-tapping screw is used on this bracket since the frame is boxed in this section.



7. The hoop mount ties into the outside of the frame rail with this bracket. Two 3/8" Nylok nuts with flat washers will fasten it to the floor and four 3/8" x 1" self-tapping screws will secure it to the frame rail. Use a 5/16" bit to pre-drill the holes.

8. Bolt the main hoop to the floor mounts using four 3/8" x 1" socket head cap screws.



9. In order to keep the "T" in the casting facing up, and the bolts facing the correct direction, **there are two different direction clamps**. Be very careful as to which clamp halves you are bolting together. Refer to the image on page 5 for clamp locations.

10. A correctly assembled clamp should look like the one in the picture shown to the left; **there should be a gap on one side for the tab to slide into**.



11. Using the template on page 6; drill four 3/8" holes into the top of the package tray.

12. Attach a "D" Clamp to the main hoop with the tab facing rearward with the top of the clamp approximately 35 1/8" above the floor mount . Use 3/8" x 1" socket head cap screws on the clamp.

13. Place the driver side package tray bar on the package tray and secure it to the clamp with a 1/2" x 1 1/2" 12 point bolt and flange nut.



14. Drop four 3/8" x 1 1/4" bolts with flat washers down through the bar mount and the holes in the package tray.

15. Fasten the trunk bar to the package tray bar with four 3/8" Nylok nuts and flat washers.



16. Using the trunk bar as a template drill two 3/8" holes through the vertical surface of the package tray.

17. Place the reinforcement plate on the inside of the package tray and secure with assembly with two 3/8" x 1 1/4" bolts, flat washers and Nylok nuts. Nuts should face the trunk.



18. Using the trunk bar as a template; mark the 4 hole in the floor pan with a center punch. First drill the hole with a 1/8" bit. Before drilling the holes to 3/8", hold the frame bracket up against the frame rail to ensure that the bolt holes will align. Re-drill 1/8" holes if necessary.

19. Drop four 3/8" x 1 1/4" bolts with flat washers down through the floor pan.



20. Secure the frame bracket to the floor pan with four 3/8" Nylok nuts and flat washers.

21. Using the bracket as a template; drill four 3/8" holes through the frame rail. Fasten the bracket to the frame with four 3/8" x 1 1/4" bolt, Nylok nuts and flat washers.

22. You may now tighten all clamps and bolts. Installation complete!

### TigerClamp Location Chart

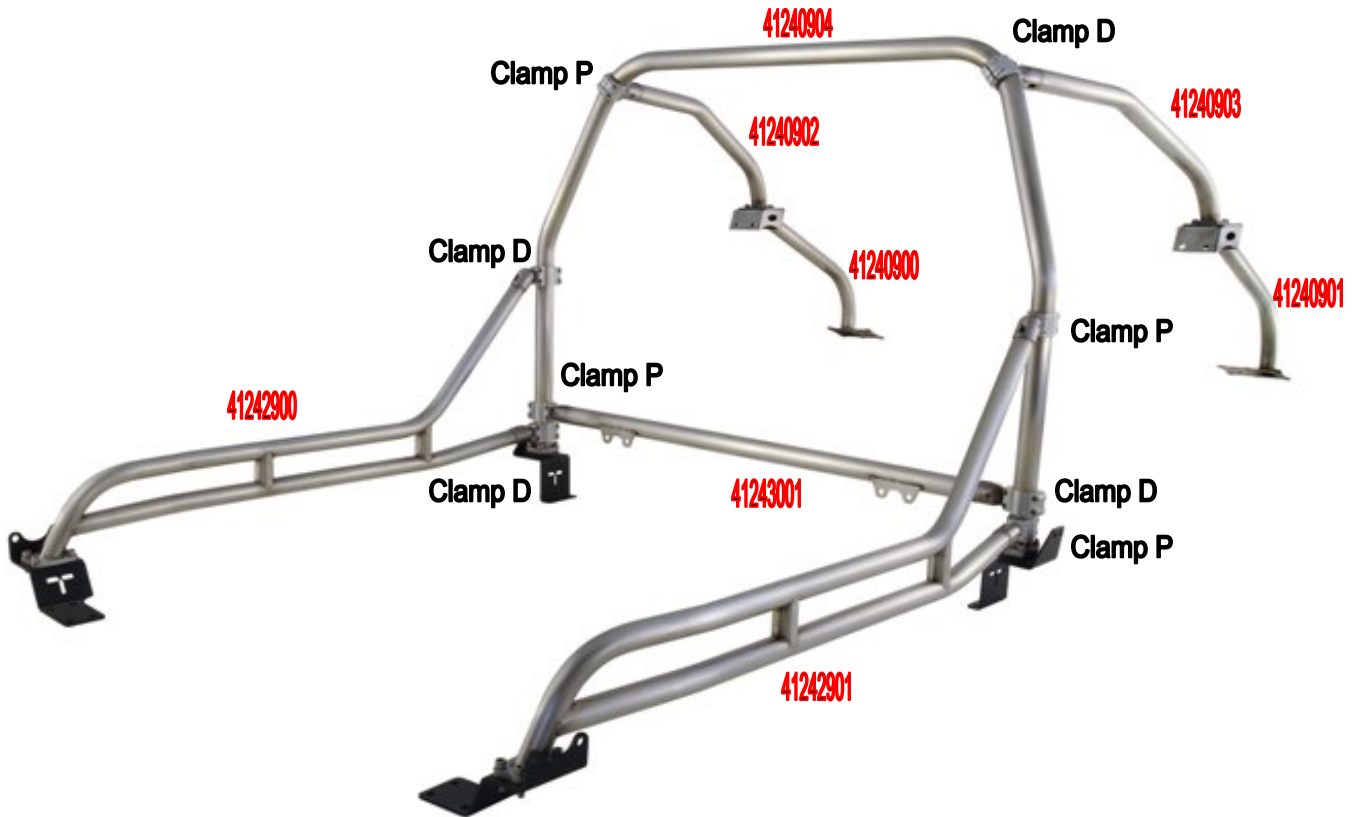

PACKAGE TRAY TEMPLATE

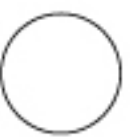

**DRIVER SIDE  
THIS SIDE UP**

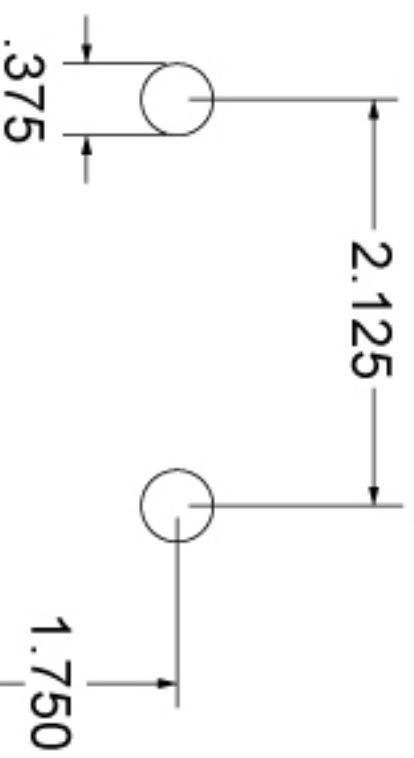

**PASSENGER SIDE  
FLIP OVER**



TO FRONT OF CAR  
(FRONT OF PACKAGE TRAY)

